

Catalog

ROBOTIC WELDING TORCHES



COBOT
... Series



EDR torches®
Evolution Design Robotics



EDR torches[®]
Evolution Design Robotics



ROBOTIC WELDING TORCHES

Collaborative robots

EDRtorches, S.L.
Calle Miguel Angel Blanco 28. 46138 -
Rafelbuñol - Valencia Spain.

www.edrtorches.com
info@edrtorches.com
Tel. 0034 963 558 893

COBOT series

Range of torches designed welding solutions with collaborative robots. This line of COBOT series torches adapts perfectly to all the requirements of collaborative robots due to its low weight and functionality.

Robust and light necks calibrated to maintain a stable TCP during the life of the torch, in addition to stainless steel structure that gives an excellent rigidity and avoids the increase of the temperature in the back areas of the neck, being able to be handled with greater ease, but always maintaining the precautions that a welding process requires.

MIG-MAG



52W Liquid cooling



TIG



T4W Liquid cooling

Index

Welding torches

Torch MIG/MAG gas 42G

6 Pag.

Torch MIG/MAG liquid 52W

8 Pag.

Torch TIG liquid T4W

10 Pag.

Update to the BOT series

12 Pag.

Accessories

22 Pag.

Cleaning station CS2

24 Pag.

Protection cover

28 Pag.

Control disc CD-2S

30 Pag.

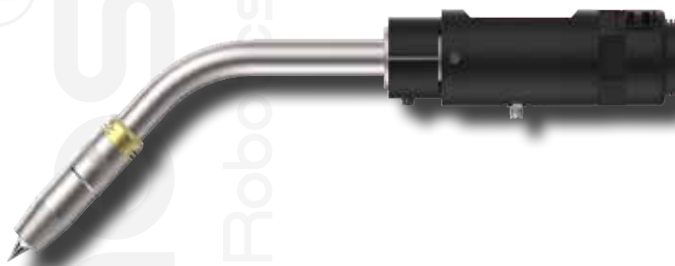

Line of COBOT torches adapts perfectly to all the requirements of collaborative robots due to its low weight and functionality.

Robust and light necks calibrated to maintain a stable TCP during the life of the torch, in addition to stainless steel structure that gives an excellent rigidity and avoids the increase of the temperature in the back areas of the neck, being able to be handled with greater ease, but always maintaining the precautions that a welding process requires.



Welding process:

MIG/MAG, GMAW, 131,135

Technical data according to IEC60974-7



Gas



300 A - CO2 100%



250 A - Mix M21 (ISO 14175) 100%



Ø1.0-1.2 mm



10-18 l/min

The capacity will be reduced by 35% with pulsed arc.

STANDARD CONFIGURATION

A

LONG. L:XXXcm



B.1

B.2

C.1

C.2

D.1

D.2

Euro type A.1

Miller type A.2

Panasonic type A.3

Pos.	TYPE	CODE	Min. Q.
A.1	Welding torch 42G-22° gas eBASIC-Euro type	R98 1xxx 22	1
	Welding torch 42G-45° gas eBASIC-Euro type	R98 1xxx 45	1
A.2	Welding torch 42G-22° gas eBASIC-Miller type	R98 2xxx 22	1
	Welding torch 42G-45° gas eBASIC-Miller type	R98 2xxx 45	1
A.3	Welding torch 42G-22° gas eBASIC-Panasonic type	R98 3xxx 22	1
	Welding torch 42G-45° gas eBASIC-Panasonic type	R98 3xxx 45	1
B.1	Guide blue L2600xØ4.6xØ1.5mm (0.8-1.0mm)-Euro	M99SR02B	1
	Guide blue L3600xØ4.6xØ1.5mm (0.8-1.0mm)-Euro	M99SR03B	1
B.2	Guide black L2600xØ5.3xØ2.2mm (1.2-1.6mm)-Euro-HD	M99 4002	1
	Guide black L3600xØ5.3xØ2.2mm (1.2-1.6mm)-Euro-HD	M99 4003	1
C.1	Guide blue L2600xØ4.6xØ1.5mm (0.8-1.0mm)-Miller type	M99 1002	1
	Guide blue L3600xØ4.6xØ1.5mm (0.8-1.0mm)-Miller type	M99 1003	1
C.2	Guide black L2600xØ5.3xØ2.2mm (1.2-1.6mm)-Miller type	M99 1102	1
	Guide black L3600xØ5.3xØ2.2mm (1.2-1.6mm)-Miller type	M99 1103	1
D.1	Guide blue L2600xØ4.6xØ1.5mm (0.8-1.0mm)-Panasonic type	M99 1302	1
	Guide blue L3600xØ4.6xØ1.5mm (0.8-1.0mm)-Panasonic type	M99 1303	1
D.2	Guide black L2600xØ5.3xØ2.2mm (1.2-1.6mm)-Panasonic type	M99 1202	1
	Guide black L3600xØ5.3xØ2.2mm (1.2-1.6mm)-Panasonic type	M99 1203	1



SPARE PARTS

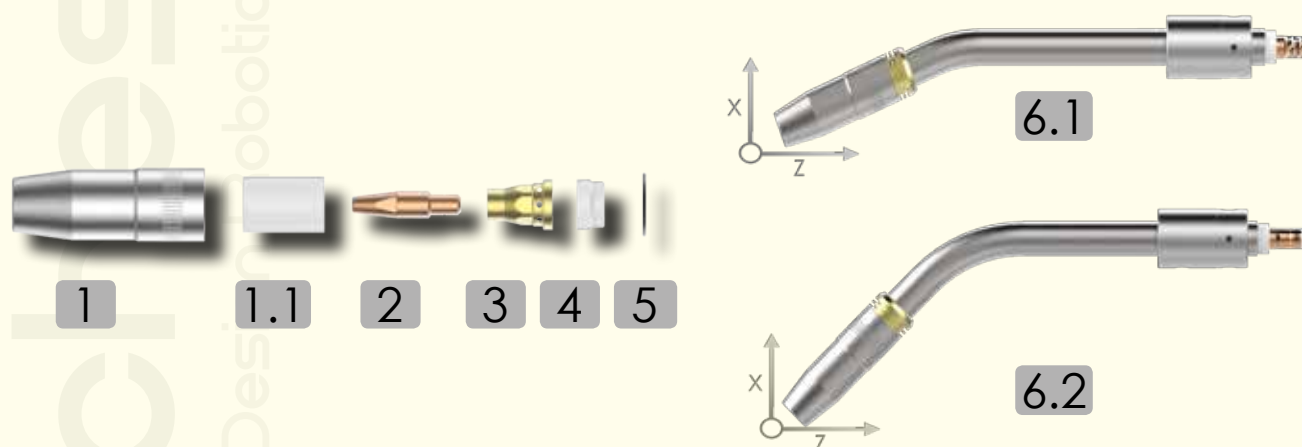

Pos.	TYPE	CODE	Min. Q.
1	Nozzle L76xØ15.5 mm	R10 0011	2
	Nozzle L76xØ13 mm	R10 0012	2
	Nozzle L79xØ15.5 mm	R10 00211	2
1.1	Insulator nozzle L35XØ19.5 mm	R10 0002	2
2	Contact tip M10 1.0 mm Cu-BICOMP	R10 0400 10	5
	Contact tip M10 1.2 mm Cu-BICOMP	R10 0400 12	5
	Contact tip M10 1.0 mm CuCrZr	R10 0401 10	5
	Contact tip M10 1.2 mm CuCrZr	R10 0401 12	5
3	Diffuser L26xØ18.5 mm M10	R12 0013	2
4	Insulator neck L11XØ18.5 mm	R12 0308	2
5	Oring neck Ø23 mm	R10 0401	10
6.1	Torch neck BASIC-42G 22° (X=50 mm, Z=263 mm)	R11 4220	1
6.2	Torch neck BASIC-42G 45° (X=111 mm, Z=227 mm)	R11 4450	1

ACCESSORIES



Pos.	TYPE	CODE	Min. Q.
9	Tip TCP M10-15mm programming	R10 0115	1
10	Clining reamer TH L26xØ15x10.5mm	R03 2040	1

STANDARD MEASURES

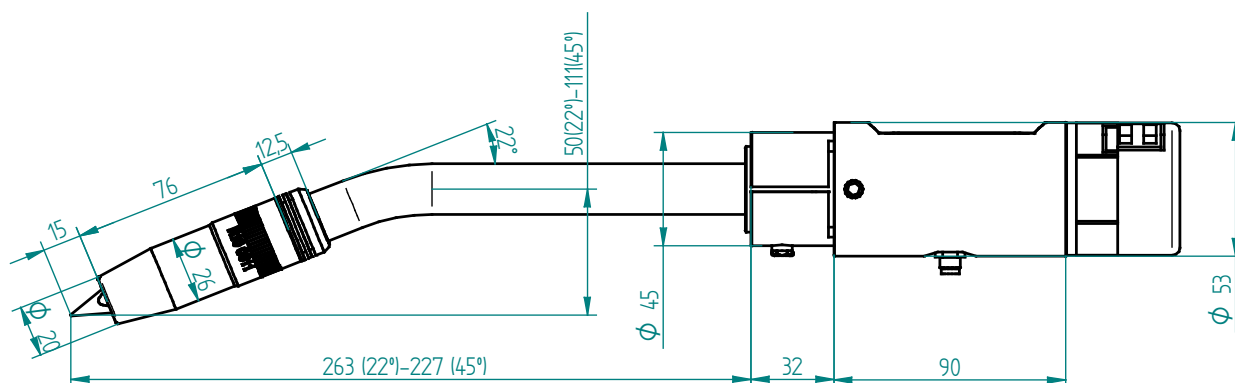

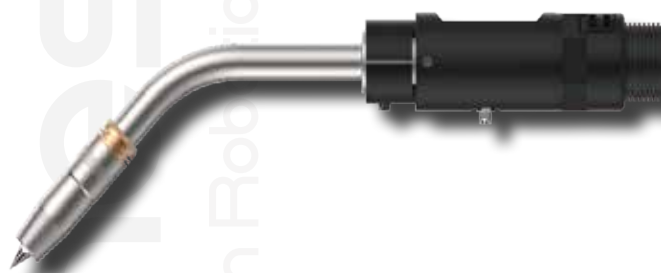

Line of COBOT torches adapts perfectly to all the requirements of collaborative robots due to its low weight and functionality.

Robust and light necks calibrated to maintain a stable TCP during the life of the torch, in addition to stainless steel structure that gives an excellent rigidity and avoids the increase of the temperature in the back areas of the neck, being able to be handled with greater ease, but always maintaining the precautions that a welding process requires.



Welding process:

MIG/MAG, GMAW, 131,135

Technical data according to IEC60974-7



Liquid



500 A - CO2 100%



400 A - Mix M21 (ISO 14175) 100%



Ø1.0-1.6 mm



10-18 l/min

The capacity will be reduced by 35% with pulsed arc.

STANDARD CONFIGURATION

A

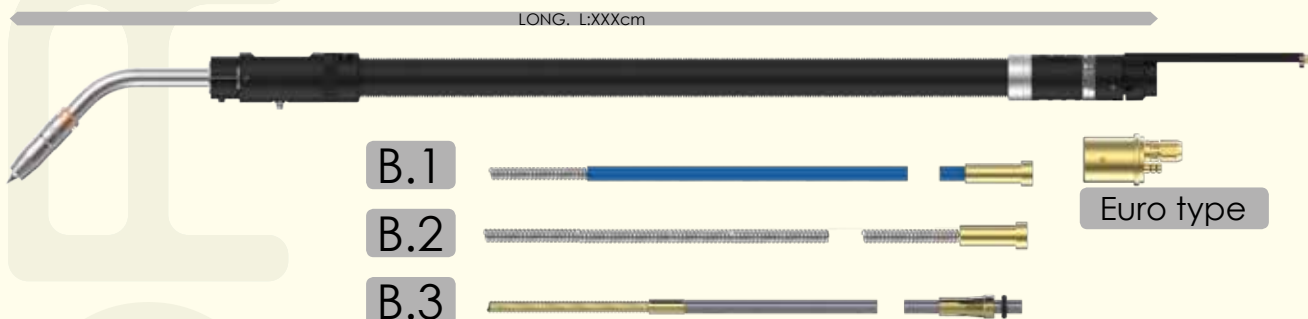

Pos.	TYPE	CODE	Min. Q.
A	Welding torch 52W-22° liquid eBASIC-Euro type	R99 1xxx 22	1
	Welding torch 52W-45° liquid eBASIC-Euro type	R99 1xxx 45	1
	Welding torch 52W-0° liquid eBASIC-Euro type	R99 1xxx 00	1
B.1	Guide blue L2600xØ4.6xØ1.5mm (0.8-1.0mm)-Euro	M99SR02B	1
	Guide blue L3600xØ4.6xØ1.5mm (0.8-1.0mm)-Euro	M99SR03B	1
	Guide blue L4600xØ4.6xØ1.5mm (0.8-1.0mm)-Euro	M99SR04B	1
B.2	Guide nude L2600xØ4.6xØ2.2mm (1.2-1.6mm)-Euro-HD	M45SR02	1
	Guide nude L3600xØ4.6xØ2.2mm (1.2-1.6mm)-Euro-HD	M45SR03	1
	Guide nude L4600xØ4.6xØ2.2mm (1.2-1.6mm)-Euro-HD	M45SR04	1
B.3	Guide for Alum L2700xØ4.5xØ2.5mm (1.2-1.6mm)-Euro	M99SA102	1
	Guide for Alum L3700xØ4.5xØ2.5mm (1.2-1.6mm)-Euro	M99SA103	1



SPARE PARTS

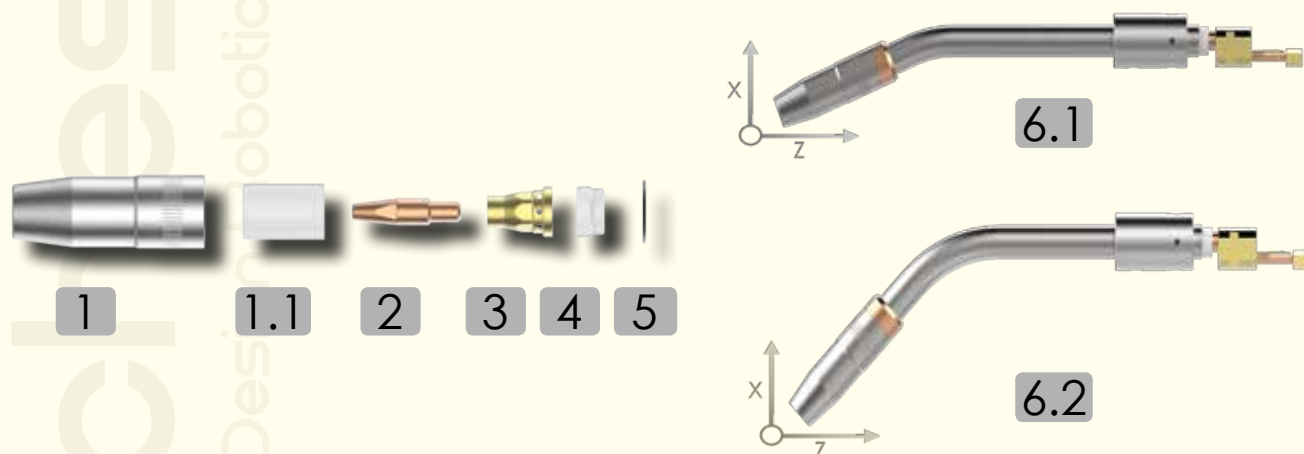

Pos.	TYPE	CODE	Min. Q.
1	Nozzle L76xØ15.5 mm	R10 0011	2
	Nozzle L76xØ13 mm	R10 0012	2
	Nozzle L79xØ15.5 mm	R10 00211	2
1.1	Insulator nozzle L35XØ19.5 mm	R10 0002	2
2	Contact tip M10 1.0 mm Cu-BICOMP	R10 0400 10	5
	Contact tip M10 1.2 mm Cu-BICOMP	R10 0400 12	5
	Contact tip M10 1.6 mm Cu-BICOMP	R10 0400 16	5
	Contact tip M10 1.0 mm CuCrZr	R10 0401 10	5
	Contact tip M10 1.2 mm CuCrZr	R10 0401 12	5
	Contact tip M10 1.6 mm CuCrZr	R10 0401 16	5
3	Diffuser L26xØ18.5 mm M10	R12 0013	2
4	Insulator neck L11XØ18.5 mm	R12 0308	2
5	Oring neck Ø23 mm	R10 0401	10
6.1	Torch neck BASIC-52W 22° (X=50 mm, Z=263 mm)	R11 5220	1
6.2	Torch neck BASIC-52W 45° (X=111 mm, Z=227 mm)	R11 5450	1

ACCESSORIES



Pos.	TYPE	CODE	Min. Q.
9	Tip TCP M10-15mm programming	R10 0115	1
10	Clining reamer TH L26xØ15x10.5mm	R03 2040	1

STANDARD MEASURES

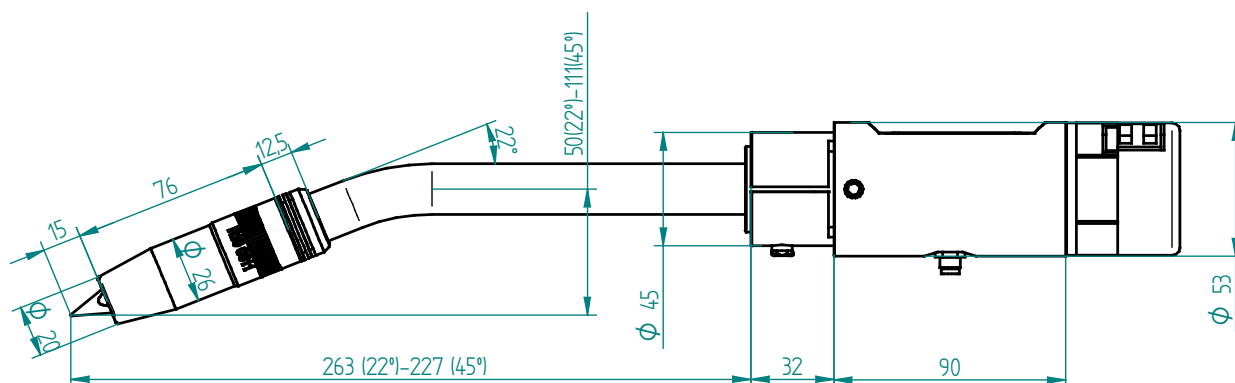



Line of COBOT torches adapts perfectly to all the requirements of collaborative robots due to its low weight and functionality.

**Welding process:**

TIG, GTAW, 141

Technical data according to IEC60974-7



Liquid



400 A - CD 100%



300 A - AC 100%



Ø 1.6-4.0 mm



4-12 l/min

The capacity will be reduced by 35% with pulsed arc.

STANDARD CONFIGURATION

LONG. L:XXXcm

A**C.1**

Euro type

C.2

Miller type

B

Pos.	TYPE	CODE	Min. Q.
A	Welding torch TIG T4W liquid BASIC - COLD WIRE Euro type	R99 8xxx E	1
	Welding torch TIG T4W liquid BASIC - COLD WIRE Miller type	R99 8xxx M	
B	Welding torch TIG T4W liquid BASIC	R99 8xxx	1
C.1	Guide TEFLON itBOT L2700xD4xD2mm(1.0-1.2)-Euro	M99 8002	1
	Guide TEFLON itBOT L3700xD4xD2mm(1.0-1.2)-Euro	M99 8003	1
C.2	Guide TEFLON itBOT L2700xD4xD2mm(1.0-1.2)-Miller	M99 1502	1
	Guide TEFLON itBOT L3700xD4xD2mm(1.0-1.2)-Miller	M99 1503	1



SPARE PARTS

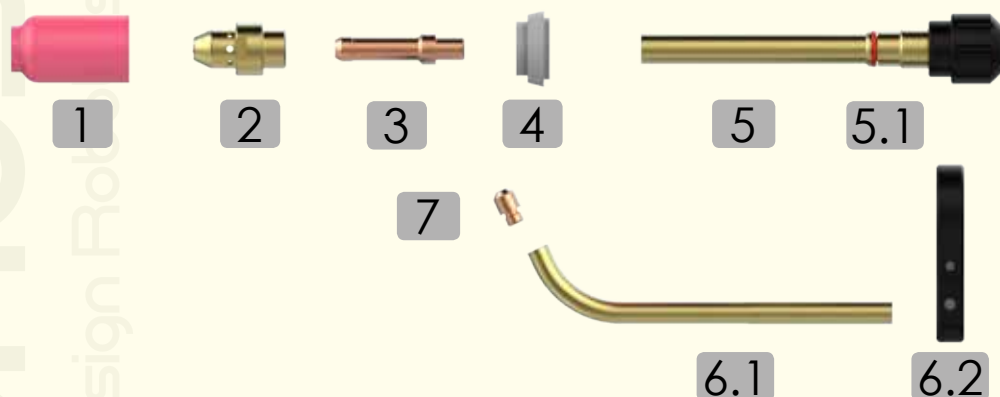

Pos.	TYPE	CODE	Min. Q.
1	Nozzle G6	R15 0100 06	10
	Nozzle G7	R15 0100 07	10
	Nozzle G8	R15 0100 08	10
2	Diffuser M14 2.4mm	R15 5304	2
	Diffuser M14 3.2mm	R15 5305	2
3	Electrode holder 2.4 mm	R15 5524	2
	Electrode holder 3.2 mm	R15 5532	2
4	Insulator Nozzle	R15 5303	2
5	Clamping element	R15 5502	1
5.1	O-ring clamping element	R15 0502	5
6.1	Wire guide	R15 0021	1
6.2	Support wire guide	R15 0022	1
7	Tip Dia 1.0 mm	R15 0110	5
	Tip Dia. 1.2 mm	R15 0112	5

ACCESSORIES

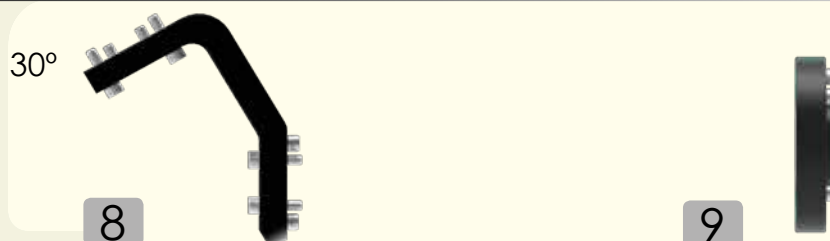

Pos.	TYPE	CODE	Min. Q.
8	Bracket CTIG 30°	R41 4001	1
9	Direct adapter disc insulator D50	R75 0021	1

STANDARD MEASURES



WEIGHT

1.062 kg
1.664 kg with 1 mts power cable



CENTER OF GRAVITY

X=0 mm
Y=78 mm
Z=109 mm



TOOL CENTER POINT

X=0 mm
Y=50 mm
Z=246 mm

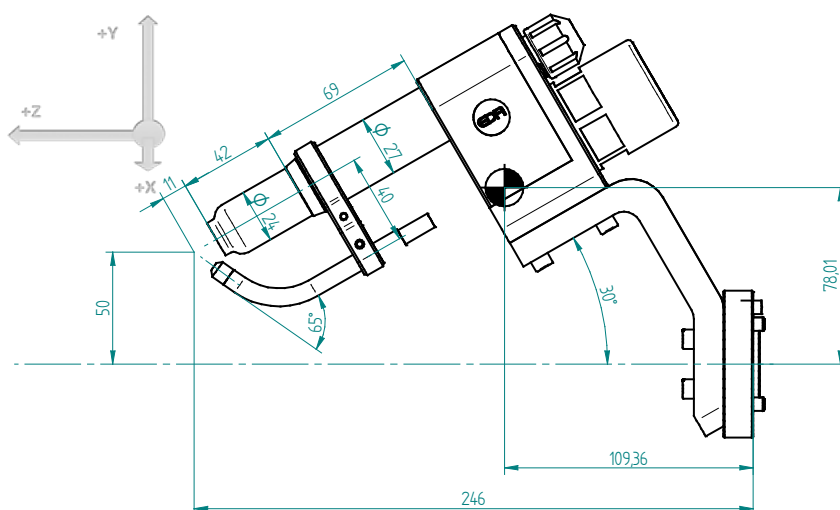

Update to the BOT series

52W



BOT 40W
-More power
-Interchangeable neck
-Double cooling



Installation codes 52W

4 Pag.

Installation codes BOT 40W

8 Pag.



52W series MIG/MAG

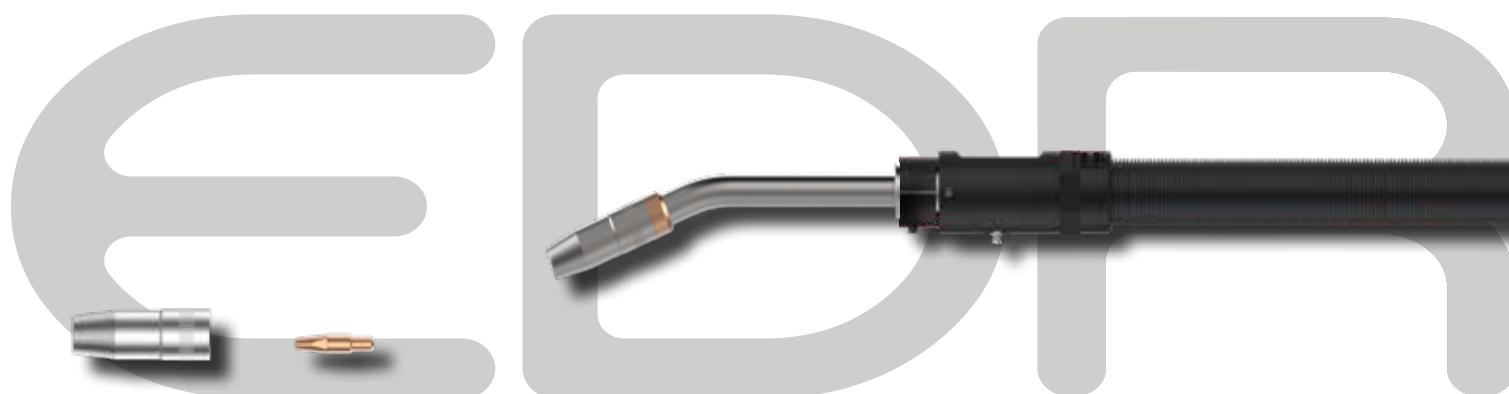

S1

S2

2

EE300	R99 1300 22	Power cable liquid Euro-3mts
--------------	-------------	------------------------------

P10	R10.0400.10	Tip M10 1.0
------------	-------------	-------------

P12	R10.0400.12	Tip M10 1.2
------------	--------------------	--------------------

P16	R10.0400.16	Tip M10 1.6
------------	-------------	-------------

T1	R10.0011	Nozzle L76xD15.5
-----------	-----------------	-------------------------

T2	R10.0012	Nozzle L76xD13
-----------	----------	----------------

T3	R10.0211	Nozzle L79xD15.5
-----------	----------	------------------

Installation code: T1-P10-EE300-67-5040-K1



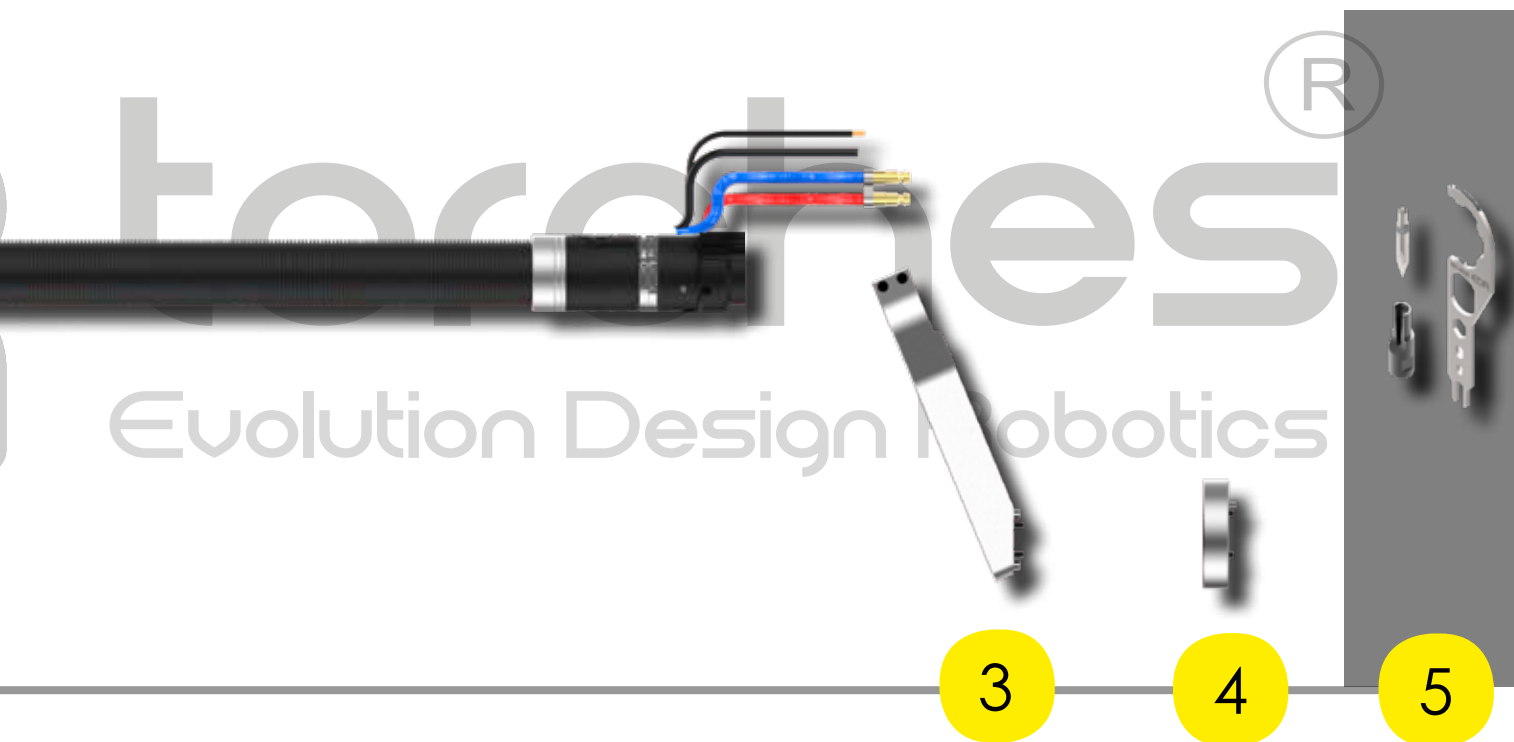

67	R41.1023	Bracket eBOT 67°
5040	R73.0020	Disco D50x4xM6
K1	R04.0000 R10.0115	Neck tool BOT TCP M10-15mm



52W series MIG/MAG

52W



The capacity will be reduced by 35% with pulsed arc.



Welding process:

MIG/MAG, GMAW, 131,135

Technical data according to IEC60974-7



Liquid



500 A - CO2 100%



400 A - Mix M21 (ISO 14175) 100%



CONFIGURATIONS

BAT5W

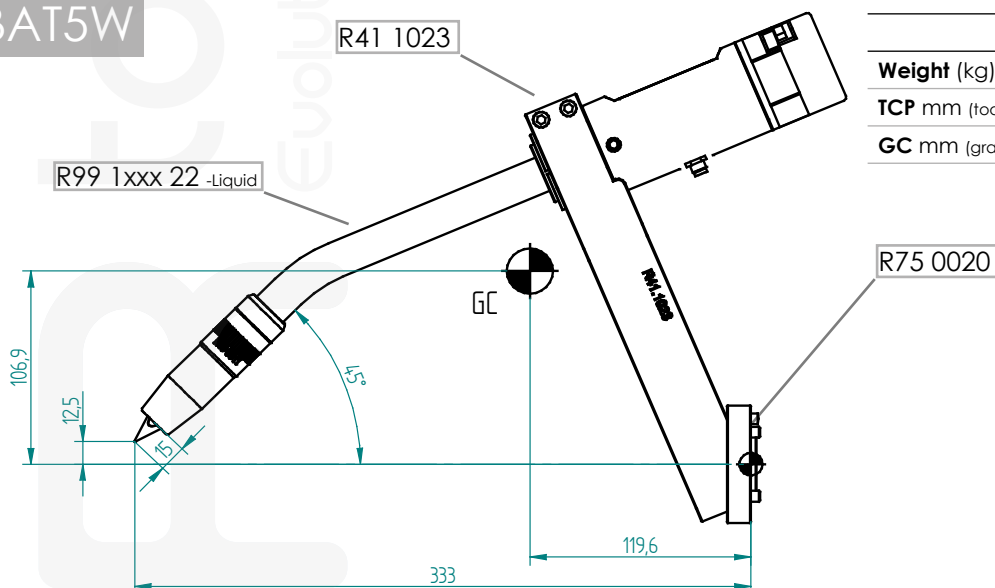

DATA

Weight (kg)	1.44
TCP mm (tool center point)	Y:12.5 / Z:333
GC mm (gravity center)	Y:106.9 / Z:119.6

BAT6W

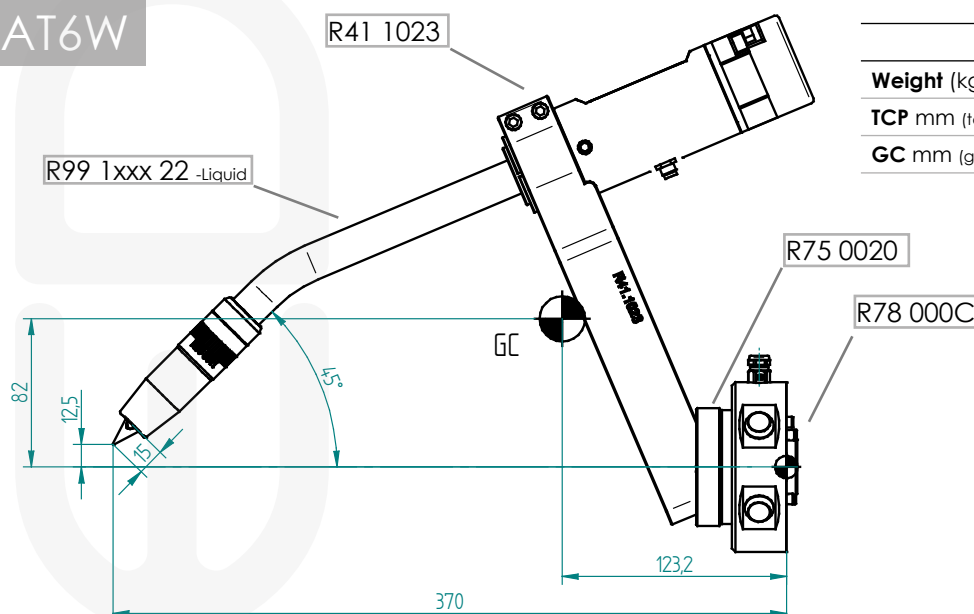

DATA

Weight (kg)	1.89
TCP mm (tool center point)	Y:12.5 / Z:370
GC mm (gravity center)	Y:82 / Z:123.2



BAT7W

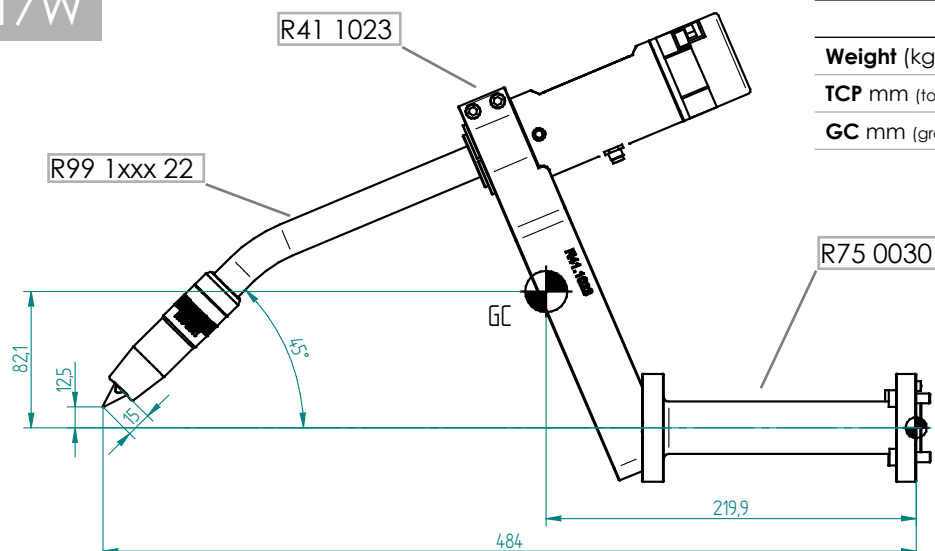

DATA

Weight (kg)	1.88
TCP mm (tool center point)	Y:12.5, Z:484
GC mm (gravity center)	Y:82.1 / Z:219.9

BAT8W

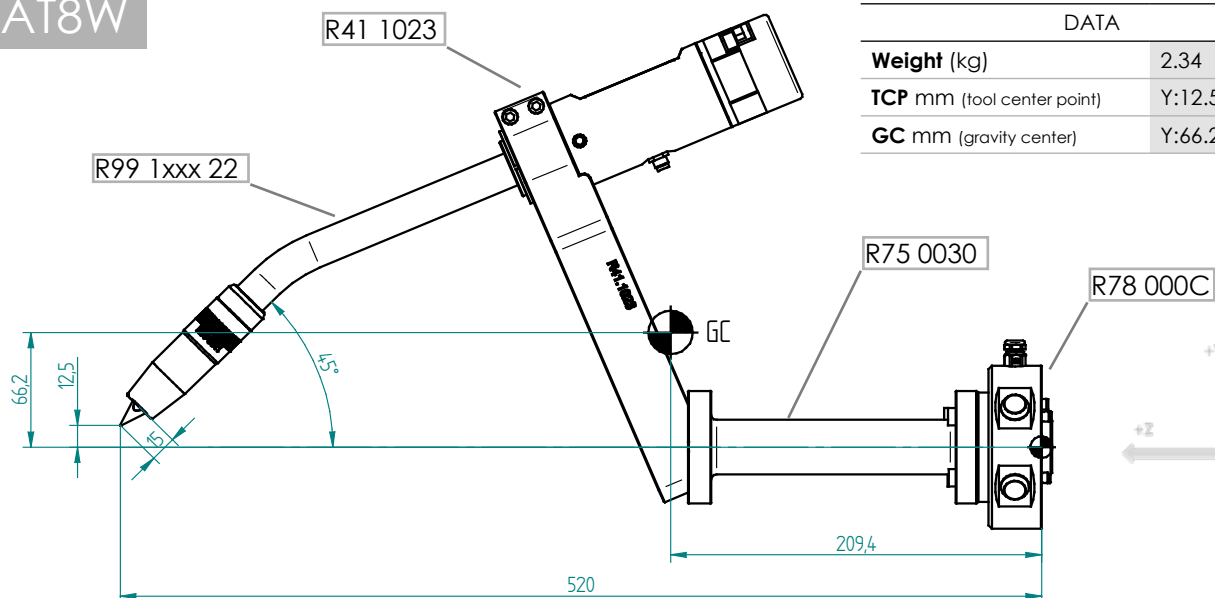

DATA

Weight (kg)	2.34
TCP mm (tool center point)	Y:12.5, Z:520
GC mm (gravity center)	Y:66.2 / Z:209.4

BAT9W

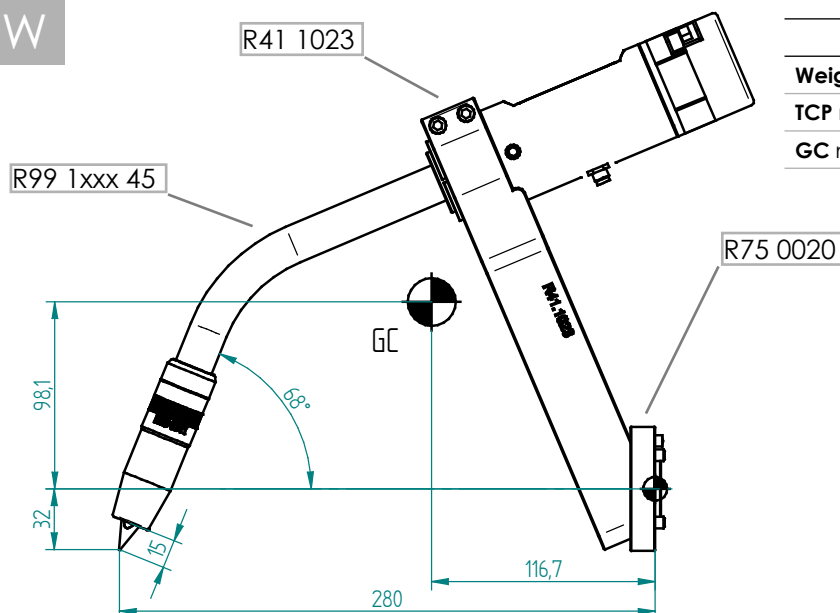

DATA

Weight (kg)	1.44
TCP mm (tool center point)	Y:-32 / Z:280
GC mm (gravity center)	Y:98.1 / Z:116.7



BOT 40W series MIG/MAG

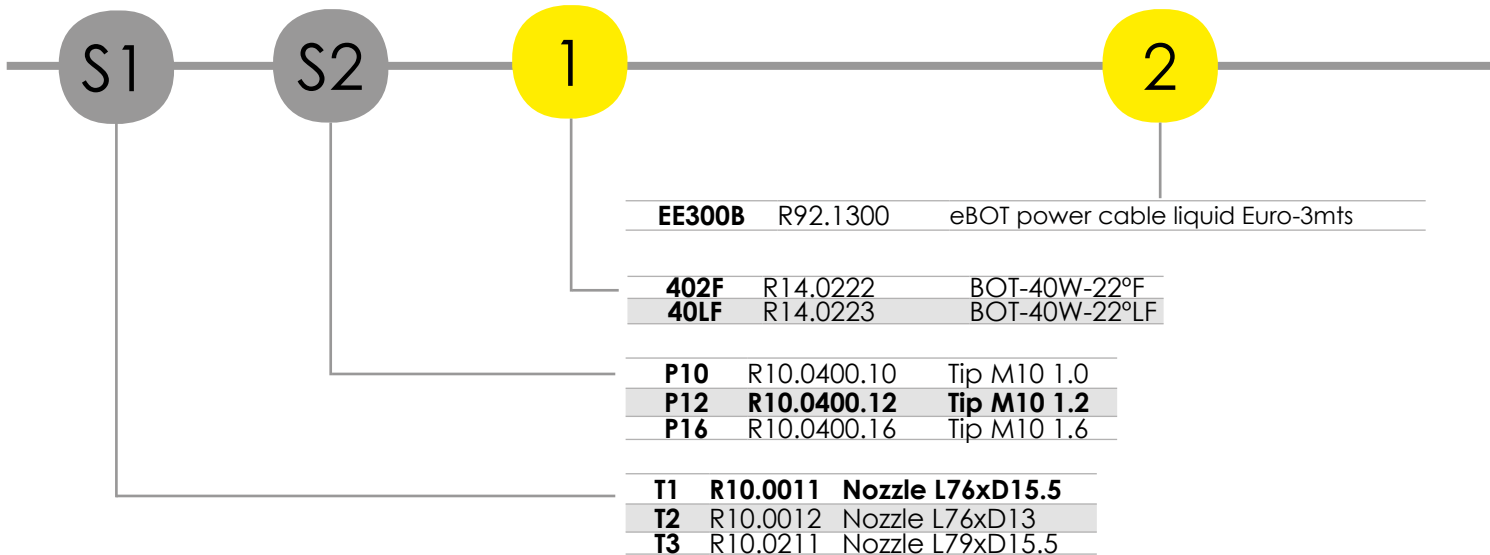
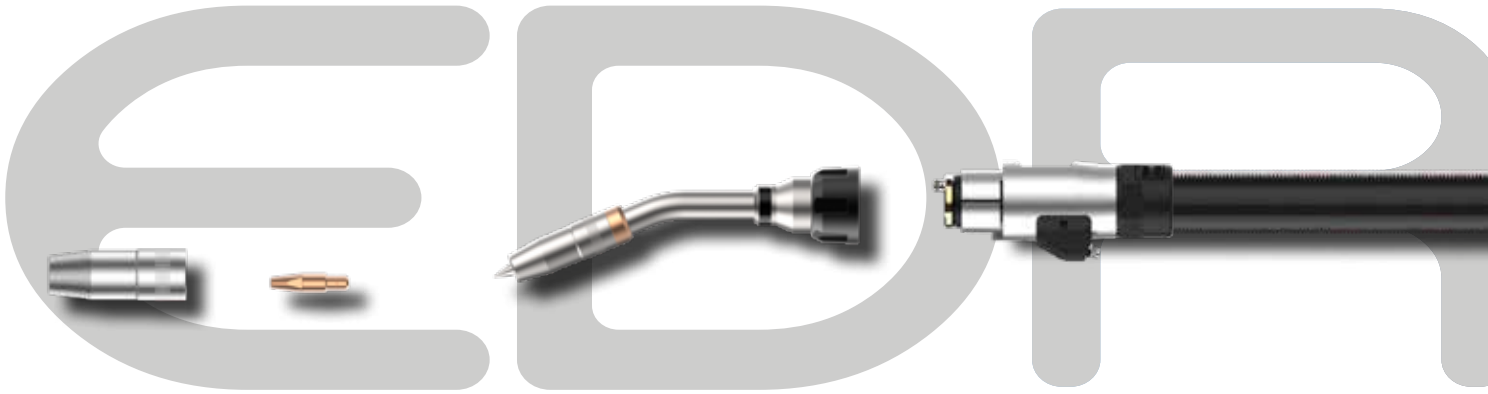

Installation code: T1-P10-402F-EE300-67-5040-K1



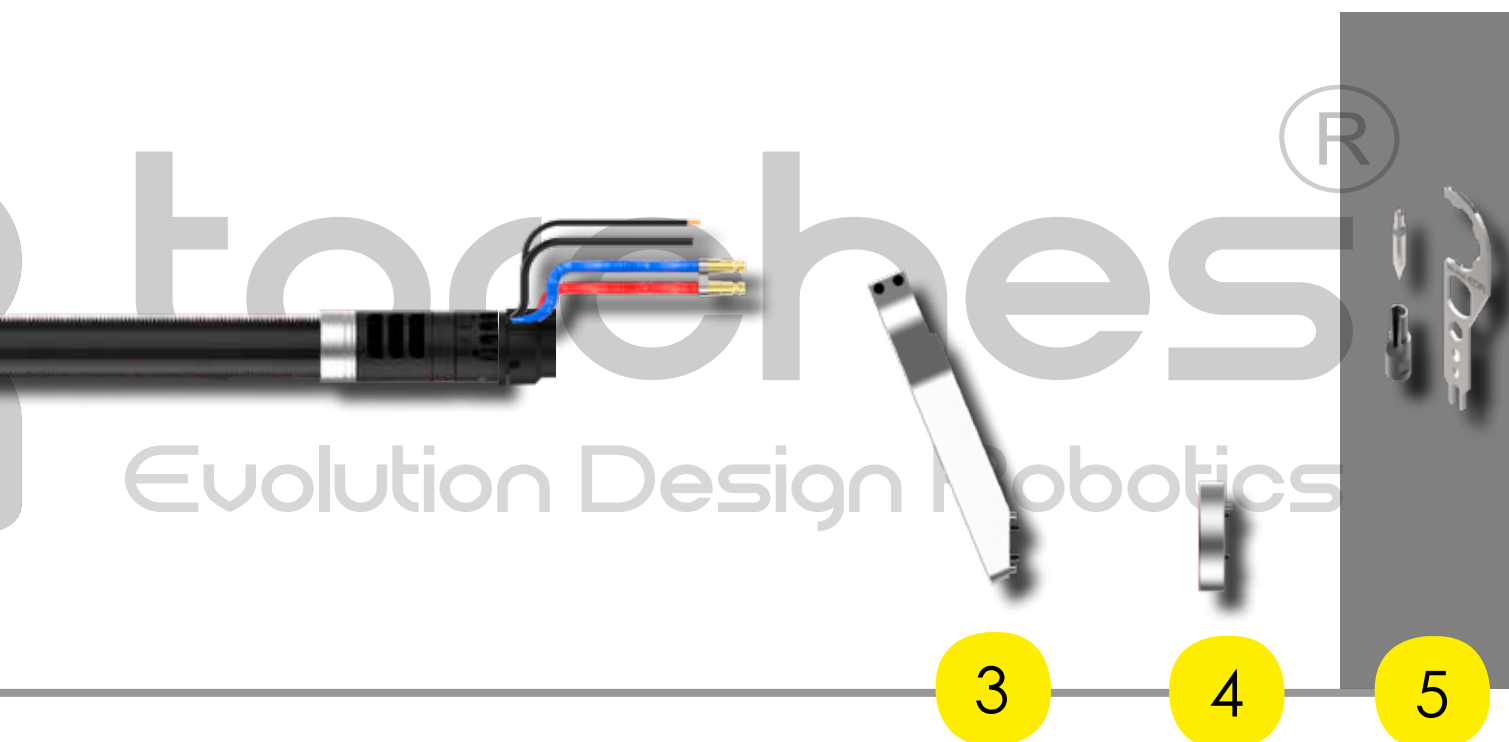

67	R41.1023	Bracket eBOT 67°
5040	R73.0020	Disco D50x4xM6
K1	R04.0000 R10.0115	Neck tool BOT TCP M10-15mm

Check the BOT series catalog
for more information



BOT 40W series MIG/MAG

BOT 40W



The capacity will be reduced by 35% with pulsed arc.



Welding process:

MIG/MAG, GMAW, 131,135

Technical data according to IEC60974-7



Liquid



500 A - CO2 100%



400 A - Mix M21 (ISO 14175) 100%



CONFIGURATIONS

BOT1W

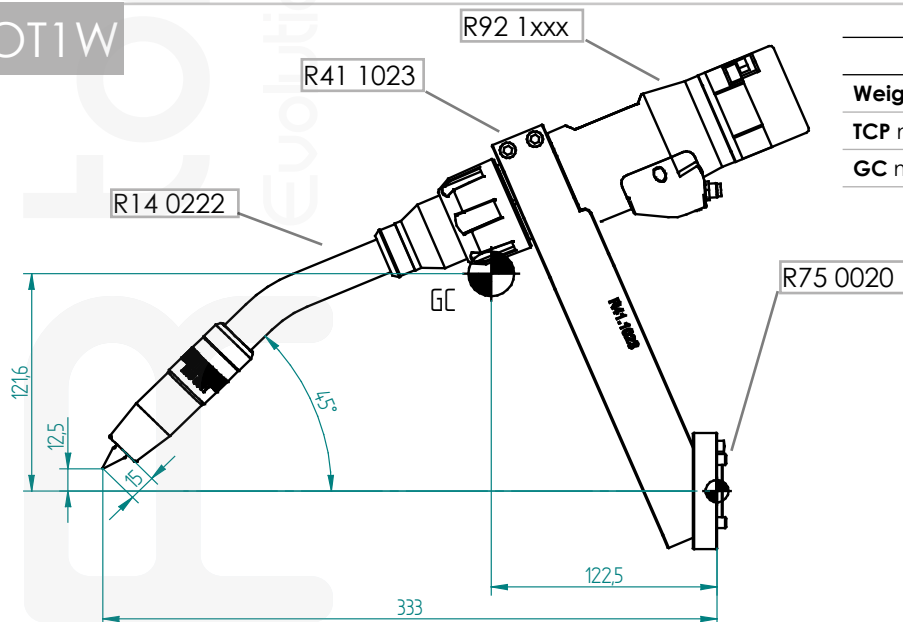

DATA	
Weight (kg)	2.10
TCP mm (tool center point)	Y:12.5, Z:333
GC mm (gravity center)	Y:121.6 / Z:122.5

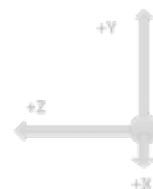

BOT2W

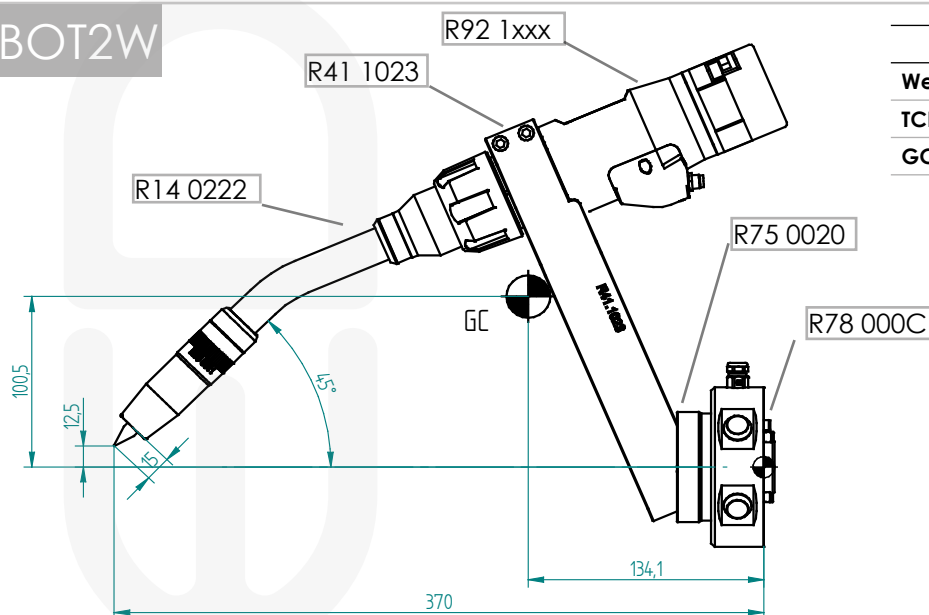

DATA	
Weight (kg)	2.54
TCP mm (tool center point)	Y:12.5, Z:520
GC mm (gravity center)	Y:100.5 / Z:134.1

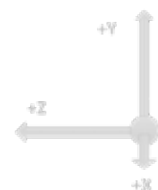

BOT3W

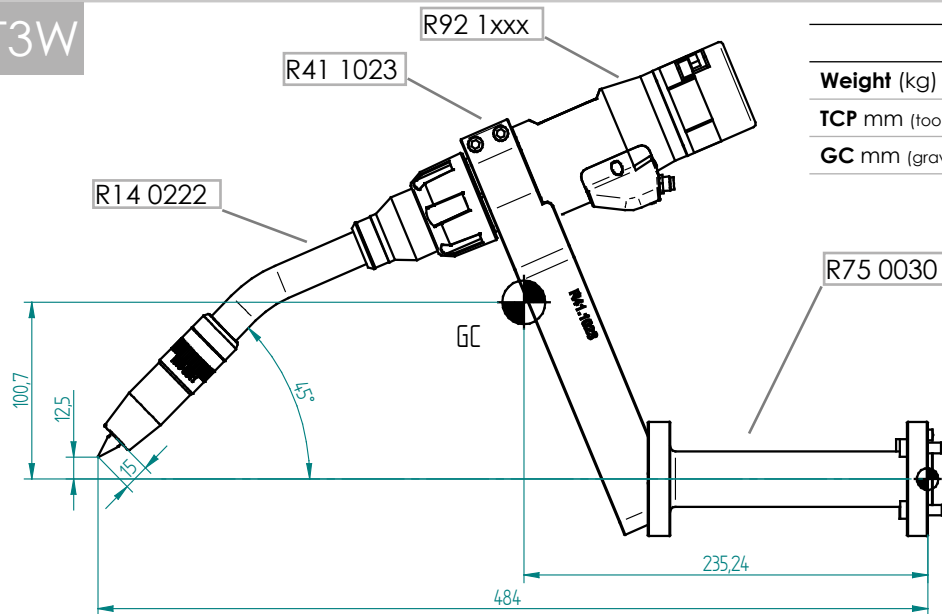

DATA

Weight (kg)	2.54
TCP mm (tool center point)	Y:12.5, Z:484
GC mm (gravity center)	Y:100.7 / Z:235.24

BOT4W

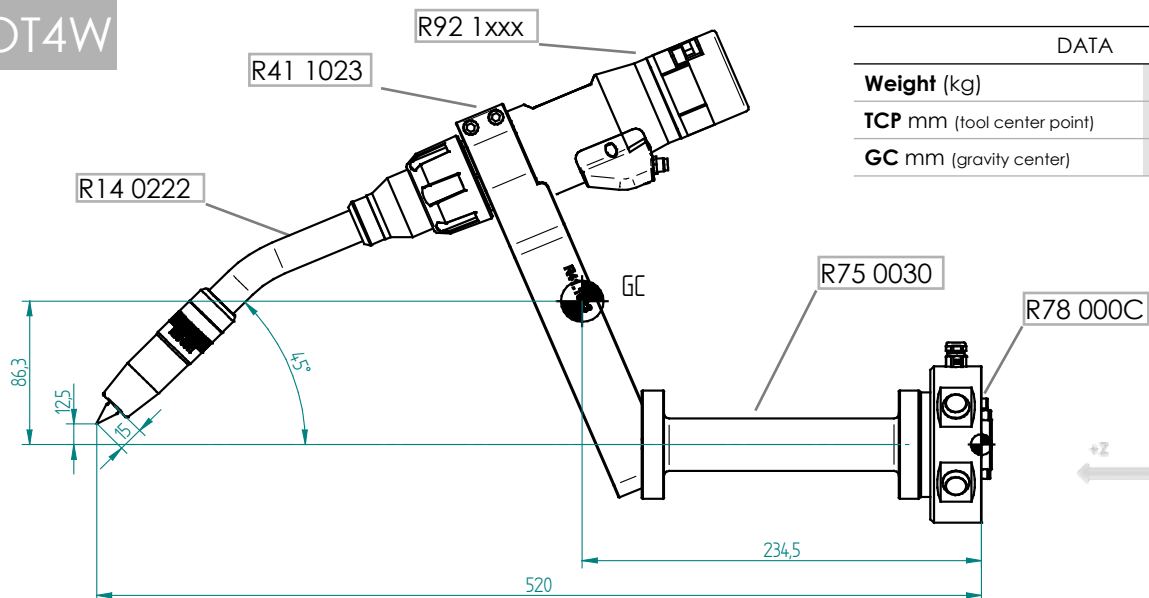

DATA

Weight (kg)	2.97
TCP mm (tool center point)	Y:12.5, Z:520
GC mm (gravity center)	Y:86.3 / Z:234.5

BOT5W

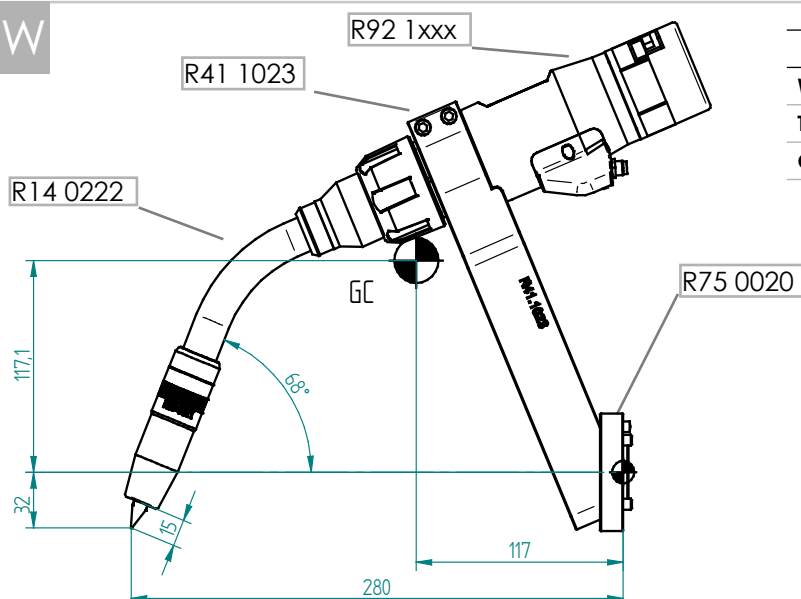

DATA

Weight (kg)	2.10
TCP mm (tool center point)	Y:-32 / Z:280
GC mm (gravity center)	Y:117.1 / Z:117

Accessories

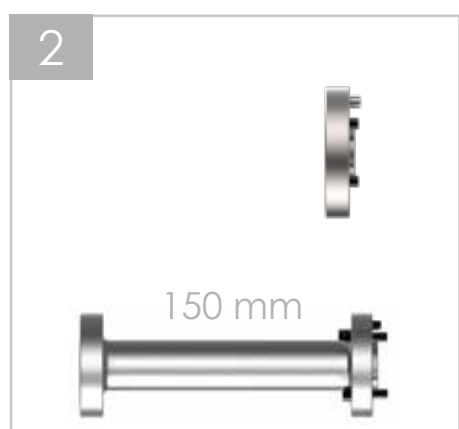
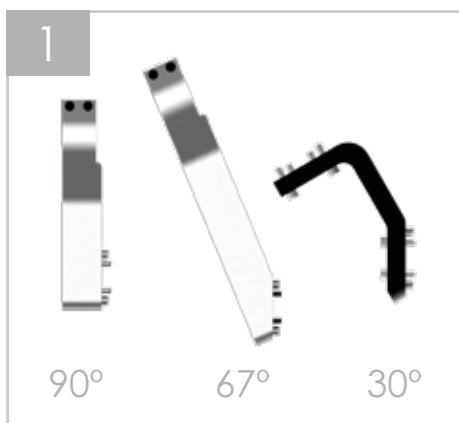

Pos.	TYPE	CODE	Min. Q.
2	Torch bracket eBOT 90°	R41 1000	1
	Torch bracket eBOT 67°	R41 1023	1
	Torch bracket CTIG 30°	R10 0115	1
3	Direct adapter disc eBOT D50	R75 0020	1
	Direct adapter disc insulator eBOT D50	R75 0021	1
	Direct adapter disc eBOT D50- Long.150mm	R75 0030	1
4	Fireproof protection cover for UR 5 CB Series	R06 1016	1
	Fireproof protection cover for UR 5 e-Series	R06 1013	1
	Fireproof protection cover for UR 10 CB Series	R06 1001	1
	Fireproof protection cover for UR 10 e-Series	R06 1012	1
5	Control disc UniBOT D50	R78 000C	1



Pos.	TYPE	CODE	Min. Q.
1	Cleaning station with wire cut (complete)	R02 2001	1
	Anti-projection liquid SPATTER FREE 5 (5l)	R07 1005	1





Nozzle cleaning station for automated and robotized welding torches. It incorporates welding wire cutting unit. Guarantees continuity of the welding process, keeping the nozzle of the welding torch free of slag and projections

Main advantages:

- Elimination of cycle interruptions due to accumulation of projections.
- Notable improvement of the initial priming efficiency while maintaining an optimum wire length
- Cleaning efficiency, short cycle time.
- Total elimination of embedded projections
- Includes TCP programming verification point



Welding process:
MIG/MAG,

- 6-8 bar *
- +5 - +50C°
- Min flow 10 l/s
- 6.3 Nm - 425 rpm
- 0.5 l spatter
- Max. 1.6 mm (solid wire)
- Max. 3.2 mm (tubular wire)
- Time cut 0.5 seg

(*) Oil-free compressed air

Choose your reamer BOT series

BOT 30G	Nozzle L76xD13mm R03 2041	Nozzle L76xD15.5mm R03 2040	Nozzle L79xD15.5mm R03 2061
BOT 31W	Nozzle L47xD13.5mm R03 2030		
BOT 40W BASIC 42G-52W	Nozzle L76xD13mm R03 2041	Nozzle L76xD15.5mm R03 2040	Nozzle L79xD15.5mm R03 2042
BOT 41EC	Nozzle L76xD15.5mm R03 2010		
BOT 50W	Nozzle L60xD15.5mm R03 2040	Nozzle L60xD18mm R03 2050	
BOT 60W	Nozzle L16xD15.5mm R03 2061	Nozzle L16xD18mm R03 2060	Nozzle L16xD21mm R03 2062

PARTS



Pos.	TYPE	CODE	Min. Q.
A	Clean station with wire cut (complete)	R02 2001	1
B	Support for cleaning station	R02 2003	1

Reamer types for BOT series

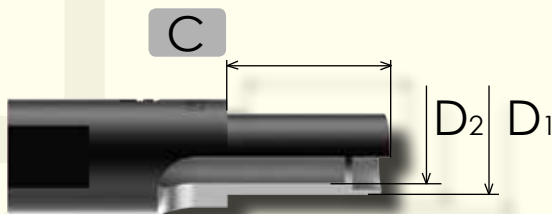

Pos.	TYPE	CODE	Min. Q.
C	Cleaning reamer TH L23xD13xD8.5 mm	R03 2030	1
	Cleaning reamer EC TH L38.5xD15xD10.5 mm	R03 2010	1
	Cleaning reamer TH L26xD15xD10.5 mm	R03 2040	1
	Cleaning reamer TH L22xD12.5xD10.5 mm	R03 2041	1
	Cleaning reamer TH L26xD17.5xD10.5 mm	R03 2050	1
	Cleaning reamer TH L29xD17.5xD10.5 mm	R03 2060	bp
	Cleaning reamer TH L29xD15xD10.5 mm	R03 2061	bp
	Cleaning reamer TH L29xD20.5xD10.5 mm	R03 2062	bp

bp: product out of stock, manufacture on demand

Spare parts

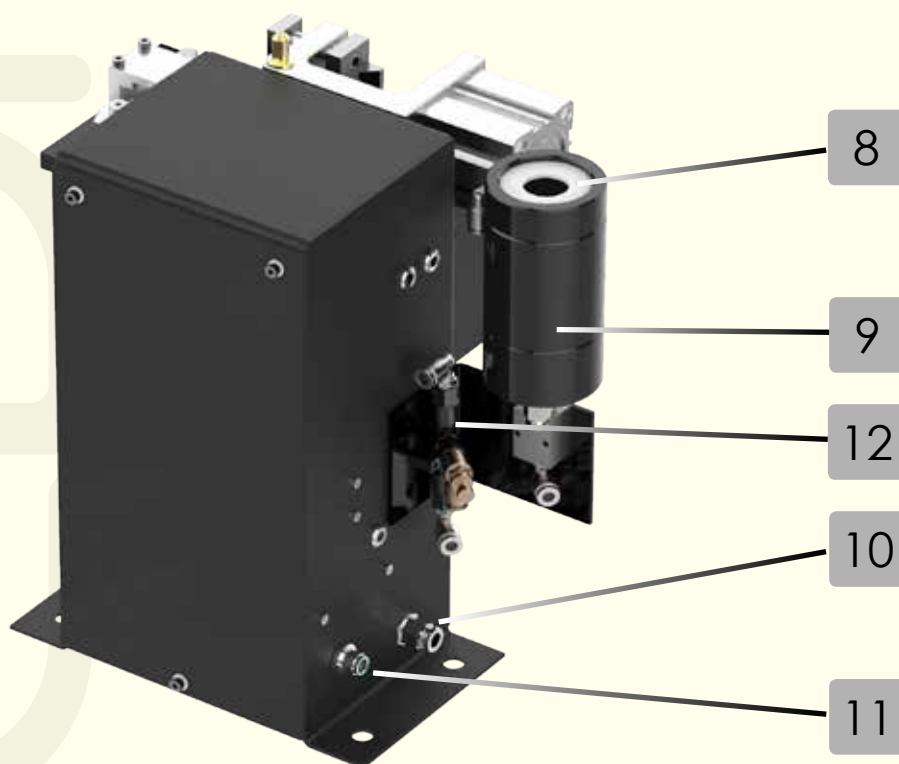
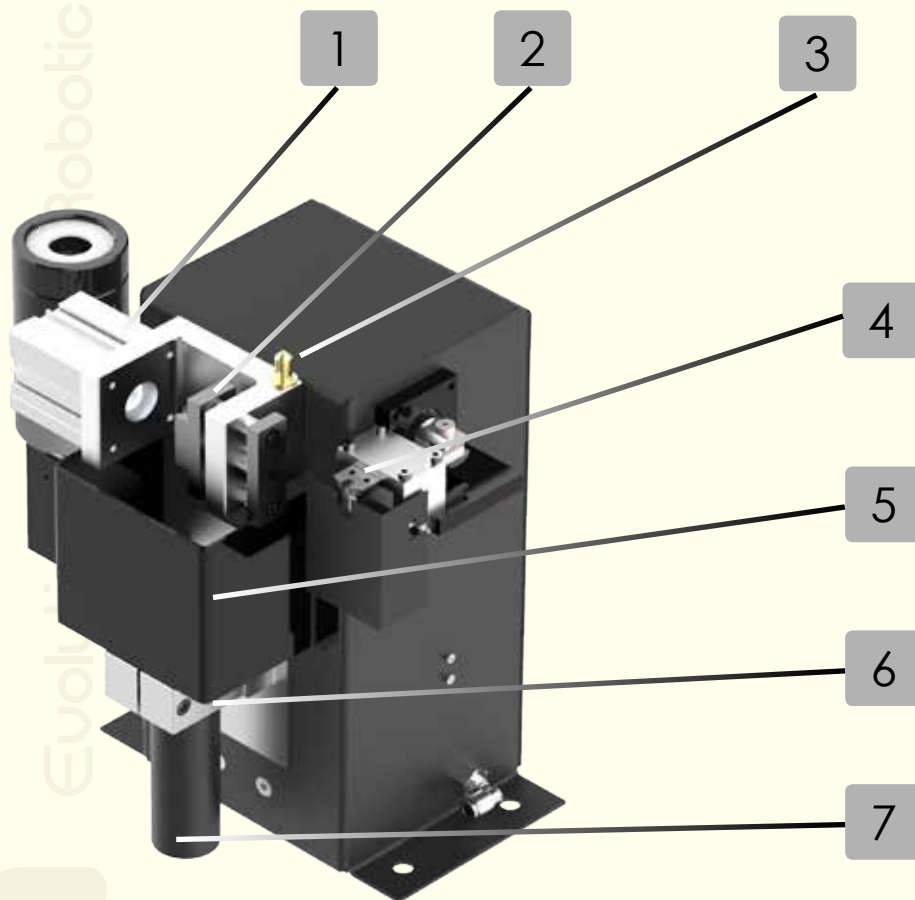



Pos.	Parts name	Functional descriptions	CODE	Min. Q.
1	Clamping cylinder	Automatic clamping welding nozzle	R02 2P01	1
2	Locater block	Fixing welding gun sprayer nozzle	R02 2P02	1
3	TCP positioning pin	TCP positioning points	R02 2P03	1
4	Wire shearing device	Wiping out needless welding wire	R02 2P04	1
5	Reamer protective cover	Preventing ejection of splash	R02 2P05	1
6	Motor mounting base	Adjusting height of pneumatic motor	R02 2P06	1
7	pneumatic motor	Driving reamer for cleaning	R02 2P07	1
8	Spray protector	Protect losses of liquid spray	R02 2P08	1
9	Anti-sling Unit	Spraying anti-sling agent	R02 2P09	1
10	Air connection port	Connecting 8mm air pipe	R02 2P10	1
11	8-pin Aviation plug	Controlling interface by robot	R02 2P11	1
12	Pneumatic distributor	Liquid control anti spatter	R02 2P12	1

Standard reamer types

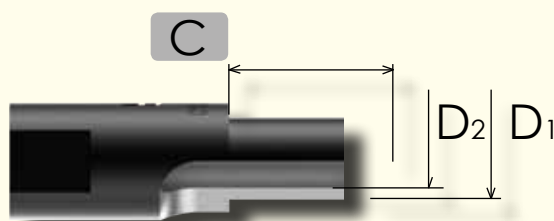

Nozzle Innerdia-meter mm	Nozzle Innerdia-meter mm	D1 mm	D2 mm	Code.	Min. Q.
10	6	9	7	R03 0907-40	bp
11	6	10	7	R03 1007-40	bp
12	6	11	7	R03 1107-40	bp
13	6	12	7	R03 1207-40	bp
13	8	12	9	R03 1209-40	1
14	8	13	9	R03 1309-40	bp
15	8	14	9	R03 1409-40	bp
16	8	15	9	R03 1509-40	bp
13	9	12	10	R03 1210-40	1
14	9	13	10	R03 1310-40	bp
15	9	14	10	R03 1410-40	bp
16	9	15	10	R03 1510-40	1
15	10	14	11	R03 1411-40	bp
16	10	15	11	R03 1511-40	bp
17	10	16	11	R03 1611-40	bp
18	10	17	11	R03 1711-40	bp
18	12	17	13	R03 1713-40	bp
19	12	18	13	R03 1813-40	bp
20	12	19	13	R03 1913-40	bp

bp: product out of stock, manufacture on demand



Product in collaboration with



Fire protection cover for Universal Robots collaborative robots

CODE	ROBOT
R06 1016	- UR 5 CB Series
R06 1013	- UR 5 e-Series
R06 1001	- UR 10 CB Series
R06 1012	- UR 10 e-Series

GENERAL CHARACTERISTICS

Description:

Protective cover for collaborative robots of the Universal Robots brand. Protection against typical incandescent welding splashes or environments where emery saw is being used. Protection against thermal radiation and UVA radiation ..

Use:

Industrial use in UR collaborative robots used in welding or in environments where hostile temperature conditions or process sparks exist

Main Advantages:

- Very low weight.
- Dimensions fully adjusted to the robot.
- Easy placement thanks to its velcro closures.
- Polyester inner lining. Anti-wear to friction.
- UV resistant.
- Resistant to high temperatures, 550°C in intermittent and 150°C in continuous.
- Resistant to welding splashes and flying sparks.

DATA



Flame retardant protection case consisting of 6 totally independent parts with each other.
Made with Fortaglas® Aluminized, (*) fabric made of fiberglass filaments and textured, with a very thin sheet of aluminum. 100% polyester inner lining.

(*) Basic woven properties of Robot Case (TVL 119)

Fortaglas® Aluminizado are fabrics made of fiberglass and textured filaments, with a very thin sheet of aluminum incorporated on 1 side. For protection applications against radiant heat.

Fortaglas® meets the requirements of the most stringent English, European and international standards for flammability applications: BS476 part 7: 1987 Class 1 and BS476 part 6: 1989 Class 0

Weight	gr/m ²	300 ±10%
Thickness	mm	0.2 ±0.1
Fiberglass diam.	micra/micron	6-9
Weave		satín
Ends-picks 10cm- * Urdimbre / warp		170
* Weft		125
Strength warp	N/50mm	1300
Strength weft	N/50mm	1800
Service temperature		
* Short periods °C	°C	550
* Continuous	°C	150



Product in collaboration with



Free-drive control and waypoint recording.



440 gr - L42.5 x Ø94 mm

COMPATIBLE ROBOTS

Universal Robots UR3, UR5, UR10, UR3e, UR5e, UR10e

COMPATIBLE CONTROLLERS (others consult)

Universal Robots CB3.0, CB3.1, e-Series

COMPATIBLE SOFTWARE (others consult)

SW 3.6.1, SW 3.8.0, SW 5.0.3

BOT MIG/MAG



BASIC MIG/MAG



BASIC TIG



GENERAL CHARACTERISTICS

Description:

Control disc for the wrist of UR collaborative robot. Two illuminated push-buttons allow free-drive control and waypoint recording in an easy and comfortable way.

These push-buttons can also be used as inputs for the user program.

It includes URCap to be installed in the robot controller.

Usage:

As accessory for Universal Robots collaborative robots.

Main advantages:

- Ergonomic. Designed for a comfortable use in the robot wrist.
- Light and strong. Machined aluminium body.
- Stylish design. Black anodized surface finished.
- Easy installation with four through-bolts. (Not included.)
- Two multi-function push-buttons with LED light.
- Easy to press buttons: Can be used with globes.

Functions with program stopped.

- Free-drive control. To adjust robot's pose with one hand.
- Waypoint recording. To add waypoints to the program.
- LEDs. Each button lights when its function is available.

Functions with program running.

- Programmable buttons. Continuation after pause, script launching, conditional programming, etc.
- Programmable LEDs. Script to configure mode and blink.



SPARE PARTS

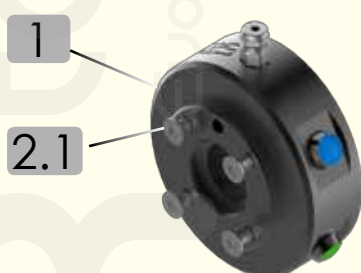
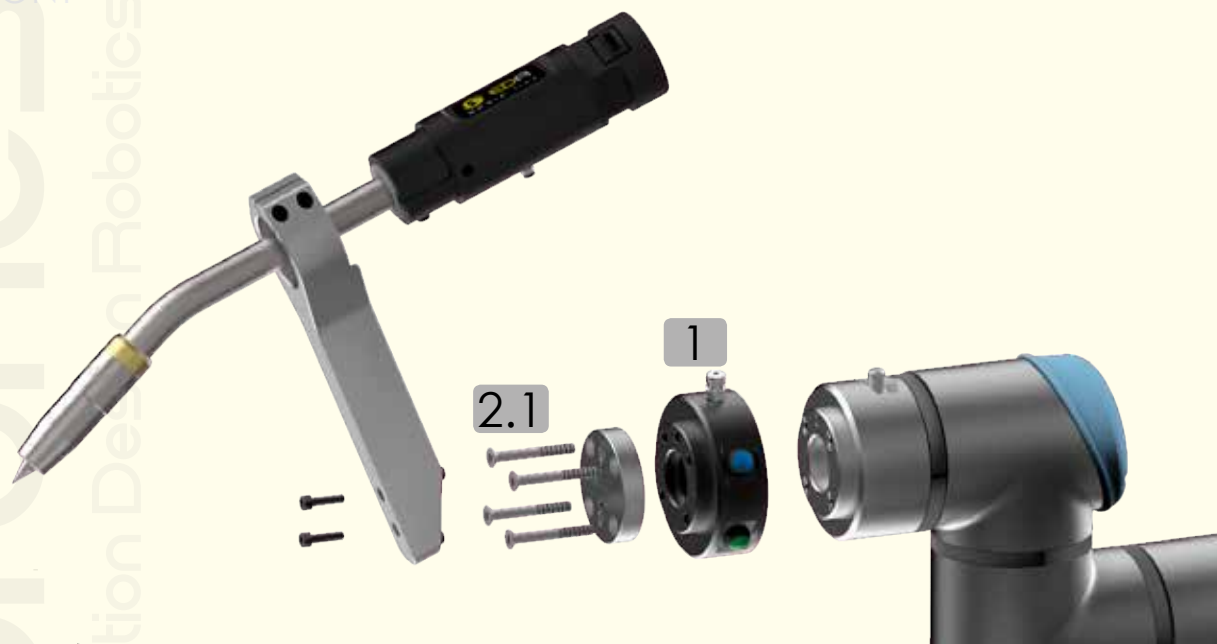

FRONT



SIDE



READ

Pos.	TYPE	CODE	Min. Q.
1	CONTROL DISC CD-2S (includes code R7 3005 02)	R78 000C	1
2.1	DISC SCREW M6x50 mm DIN7991 (For standard disc)	R7 3005 02	1
	DISC SCREW M6x50 mm DIN912 (For long adapter disc, code R75 0030)	R7 3005 03	1

STANDARD MEASURES

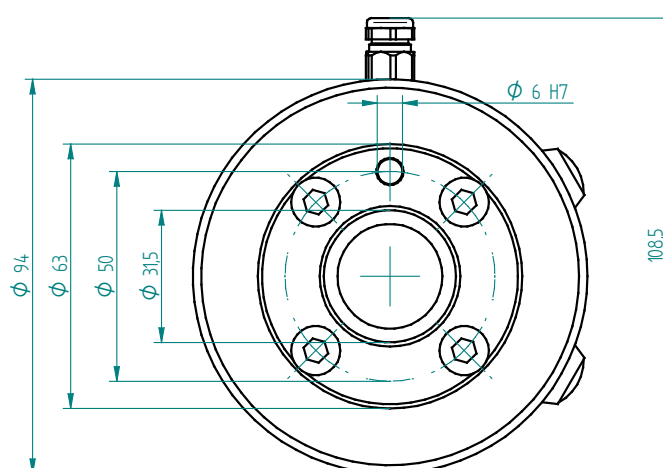
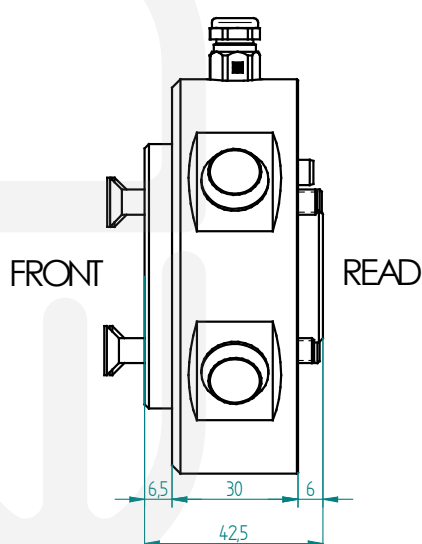

Robotic welding torches

Collaborative robots



EDRtorches, S.L.
Calle Miguel Angel Blanco 28. 46138
Rafelbuñol - Valencia Spain.
www.edrtorches.com
info@edrtorches.com
Tel. 0034 963 558 893

